

SMALLEST MOBILE HOSPITAL OF THE WORLD

EMERGENCY CELL UNIT ISO 1 DD
MOBILE EXTENDED SURGICAL or DENTAL RESCUE ASSY IN 3 CON-
TAINERS
ISO 668 / ISO 1 DD EDGE COUPLED SMM 110 EC (EMERCELL™)
(special construction and connection)



ISO 1496 forklift rails
ISO 1161 corner fittings
CSC plated
NCAGE



(NATO Commercial and Governmental Entity Code)
EN ISO 9001 : 2001 / EN ISO 9001 : 2000
(Management based on ISO 9001:2001 applied in the production)



EMERGENCY UNIT PROJECT

SPECIAL SUPERSTRUCTURE ON OFFROAD TRUCK OR SEMISTATIONARY

EMERGENCY UNIT ISO 1DD EXTENDED CONTAINER

REGISTERED TRADE MARK
EMERCELL™

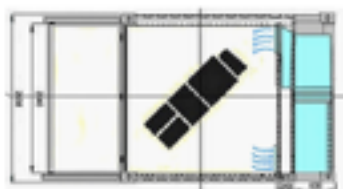

PROJECT SMM 110
CODE MMCS-EC
TYPE 227
MODIFICATION 0



Example of the ISO 1 DD 10' container and off road truck



MTN TECHNICAL DEVELOPMENT OFFICE

MEDICAL TRADE NETWORK PROJECTS, DEVELOPMENT, CONSTRUCTION
AND DOCUMENTATION PROGRAMS 2016 - 2018

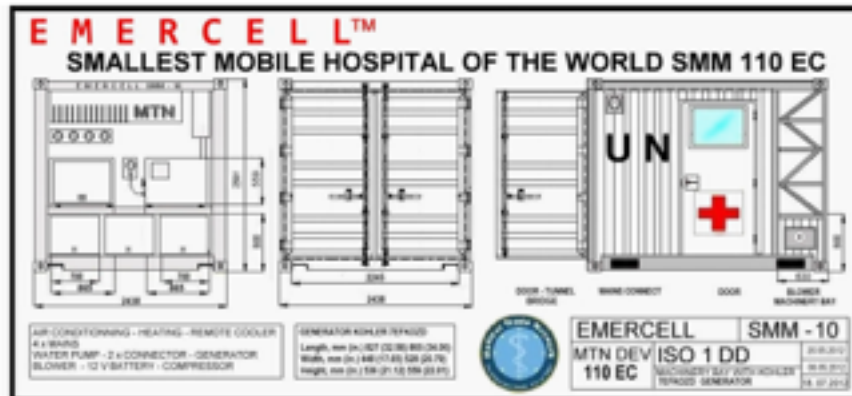

5/11/2017

MTN

29



MTN TECHNICAL DEVELOPMENT OFFICE

We worked out a range of medical container types in two sizes, 10 feet and 20 feet. The modularity of used parts and the production process on more involved places are inspired from the methods by manufacturing Airbus aircrafts

SMM 110 EMERCELL™, the small one surgical unit, is the ultimate solution for NGOs, fire brigades, industrial complexes, oil fields and for basic tasks by UN medical troops allowing class 2 location safety conditions like in modern hospitals in concrete buildings

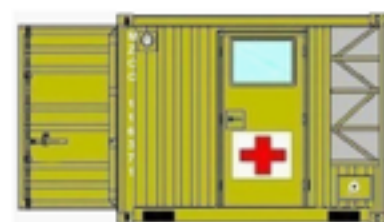

"First of a new generation of life saving modules"

5/11/2017

MTN

20



MTN TECHNICAL DEVELOPMENT OFFICE

We worked out a range of medical container types in two sizes, 10 feet and 20 feet. The modularity of used parts and the production process on more involved places are inspired from the methods by manufacturing Airbus aircrafts

SMM 110 E M E R C E L L™, the small one surgical unit, is the ultimate solution for NGOs, fire brigades, industrial complexes, oil fields and for basic tasks by UN medical troops allowing class 2 location safety conditions like in modern hospitals in concrete buildings



"First of a new generation of life saving modules"

5/11/2017

MTN

19

General description

The ISO 1 DD 10 rugged steel maritime type containers are housing the **MOBILE EXTENDED SURGICAL or DENTAL RESCUE ASSY**

The three containers are full adapted for medical purposes and equipped with electrical wiring, redundant two sources water distribution, waste water drain with pumping, lighting, heating and air conditioning. The **ECU-MES or DRA** contains the **EMERGENCY CELL UNIT ISO 1 DD MOBILE EXTENDED SURGICAL or DENTAL RESCUE ASSY** workplace and devices with doctor's and patient's entry door on the side, Laboratory room, washroom and the last one as patient ward. The one redundant electric power generator is of 230 V 50 Hz 9 KW type. The containers operates can loaded on his own containers 8 x 8.2 truck or on trailer, but can work deloaded, connected to water and power networks too by semi-stationary purposes

The **MOBILE EXTENDED SURGICAL or DENTAL RESCUE ASSY** is 24 hours fully independent of outside support, but can work connected to public water and power networks too

The **MOBILE EXTENDED SURGICAL or DENTAL RESCUE ASSY** provides with his advanced surgical or dental equipments all important medical tasks in examinations, patients triage and small to middle surgical or dental operations. The construction of the **EMERGENCY CELL UNIT ISO 1 DD MOBILE EXTENDED SURGICAL or DENTAL RESCUE ASSY** is adapted for work in heavy environmental conditions, is classified as interchangeable superstructure

Assembly of 3 ISO 1 DD 10' containers

Three different workplaces are provided in this assembly in containers

- Surgical or dental operation theatre and as preparatory room
- Laboratory and doctor's room
- Patients ward

Drawings, pictures and other documents



MTN TECHNICAL DEVELOPMENT OFFICE

MTN E M E R C E L L automotive surgical unit of 10 feet type is the ultimate solution of small rugged disaster vehicle for heavy conditions - special exchangeable superstructure ISO 668 mounted on a OFF ROAD transporter, designed especially for UN medical troops and for non governmental humanitarian help organizations. (NGO)



"Between the idea and the innovative solution there is the work in network"

5/11/2017

MTN

24

Example of the ISO 1 DD 10' container and off road truck



SURGICAL ASSEMBLY DRAWING

SURGICAL RESCUE ASSY IN 3 CONTAINERS ISO 1DD "ACCORDEON"

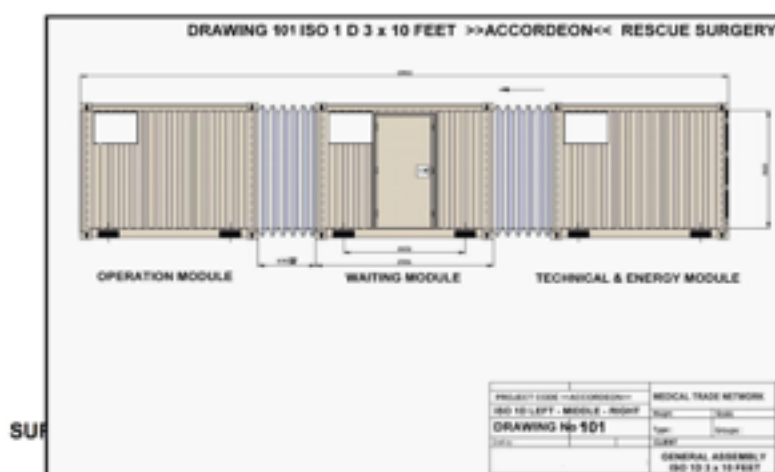

5/14/2017

MTN

103

Example of the schematic drawing of the surgical operation theatre containers 3 x ISO 1 DD
 At the right connection place a inflatable tent can be tied

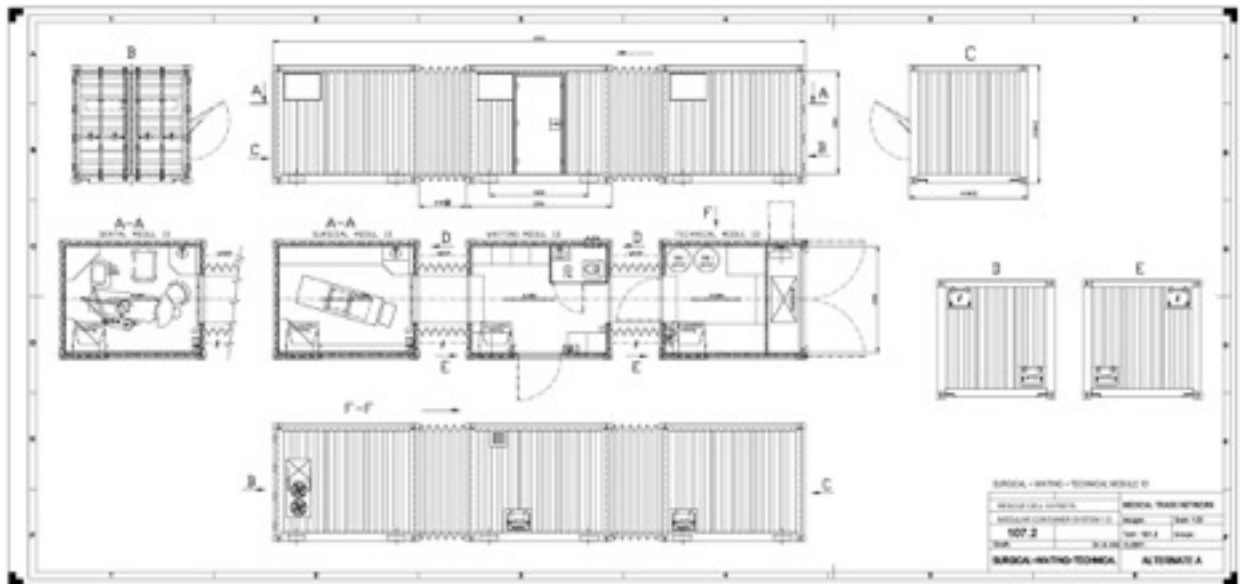

MTN™ is the registered Trade Mark of Medical Trade Network Company

Example of the schematic drawing of the special construction and connection of the operation or dental theatre container 3 x ISO 1 DD



Example of the inflatable tent picture



MTN TECHNICAL DEVELOPMENT OFFICE

We worked out a range of medical container types in two sizes, **10** feet and **20** feet. This allows produce up to 128 various unit models. The modularity of used parts and the displaced production process on more involved places are inspired from the networking methods by manufacturing Airbus aircrafts

ISO 668 / ISO 1 DD
SMM 110
EMERCELL™



"First of a new generation of life saving modules"

5/11/2017

MTN

18

ISO 1 DD 10' container construction and materials

Containers structure and ISO corners are made of steel. For manipulation by forklift, lifting points are implemented. Walls are made of trapezoidal steel sheet (thickness up to 1.5 - 2 mm). Insulation for ceiling and walls is made of 40 mm sandwich panel assembled on the inside of the container. These panels are made of aluminum skins (thickness 0, 8 mm) and polyurethane foam core (ELASTOPOR SH 226 / 003 density 65 g / dm³) can be optionally insulated against ionizing radiation too. Reinforcement inserts can be integrated inside the panels where requested. Insulation of the floor is 50 mm sandwich panel. These panels are made of one aluminum skin (thickness 0, 80 mm), polyurethane foam core (density 65 g / dm³) and plywood (thickness 18 mm). The container is painted on the outside with polyurethane painting U 2056. The inside painting is white (standard color of the painting of the sandwich panel aluminum sheet). The floor is covered by vinyl floor mat - NON SLIPPERY ALTRO finish. Color schema for walls and ceiling - polyester varnish HF 1F50 of ARCTIC WHITE color (code 966RB). External or internal color is PU varnish, standard white. Color schema can be customized on customer request

Quality control and applied certifications

The manufacturer's production methods and quality control are certified and the products complies the certifications for maritime ISO containers, road, ship, train transport, including the compatibility with container manipulation devices and allows the certifications EN ISO 668, ISO 9000 : 2001, EN ISO 9000 : 2000, ISO 1496 forklift rails, ISO 1161 corner fittings, CSC, IAF, NCAGE



STANDARDS AND ISO CERTIFICATION

The production methods and quality control of the involved manufacturers are certified and the products complies the certifications for maritime **ISO 668** containers, road, ship, train and airlift transport, including the compatibility with container manipulation devices and allows the certifications **EN ISO 9000:2001**, **EN ISO 9000:2000**, **ISO 1496** forklift rails, **ISO 1161** corner fittings, **CSC**, **IAF**, **NCAGE**. All material used for container framework is certified by German Lloyd certification agency. The Electro-technical cabinet and installation are equipped with special protection transformer in accordance with **DIN VDE 0100-710:2002-11** for medical locations **class 2** and other norms like **IEC 60439-1**, **DIN EN 60439-1**, **DIN VDE 0660 part 500**, **DIN VDE 0106 part 100**, **IEC 1641** and **DIN VDE 0660 part 500, 2**. Water Installation complies the **DIN 1717**, **DIN 1988-100**, **DIN EN 806-1**, **DIN EN 806-2**, **DIN 1988-200**, **DIN EN 806-4**, **DIN EN 806-3** **DIN 1988-300** **DIN EN 806-5**, **DIN 17660**, **DIN 50930/6**, **DVGW W 270**

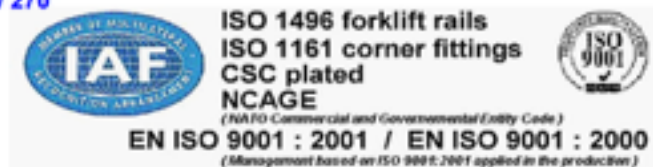

5/11/2017

MTN

31

The doors

The **MOBILE EXTENDED SURGICAL or DENTAL RESCUE ASSY** containers are entered alternatively from the side through a single-wing door of customizable size (standard size, other dimensions on request). The firm construction door is with an aluminum frame. The door is fitted with a wheelbase lock and handle with a patent lock. Another lock is placed under the handle, which secures the wheelbase of the main lock when locked. The door is sealed all around. Rubber seal used for door sealing is rigid, elastic and resistant against erosion and sea water

Anti-vibration fastening of the components, ANCRA

The medical devices included movable components of the equipment are mounted and fastened with use of silent-blocs, the small vibration producing devices are sound and vibrations isolated. During of the transport a multipurpose side strips ANCRA are mounted on side and / or front walls of container. Side strips are used for fastening of fastening straps. Fastening straps are stored in holder that is mounted for this purpose on the wall of the containers

Power supplies and IT secured electrical cabinet installations

Outside of the **ECU-MESorDRA** interior are placed one small vibration producing devices of nominally power 1 x 9 KW diesel-electric super silent generators in own sound shielded boxes, further the air conditioning, heating and filtering unit, an electric interface connection box is added to one of the medical containers. The power generator are wired with the **IT (Isolated Terra) secured electrical cabinet** for medical class 2 rooms with temperature and isolation monitored transformer. Connection box for public electric power supply system assure longtime functionality by semi-stationary use. The three sources are switched automatically trough a redundancy function of the IT secured electrical cabinet. This electric installation is an intelligent system for a safe and reliable IT (Isolated Terra) power supply and is compliant to the standard for medical power supplies of class II rooms (VDE0100 - part 710). The generators place is secured trough two wings anti-vandalism rugged doors

Interior medical equipment

Is intended to provide small to middle surgical or dental operations under gaseous anesthesia without C-Arm x-Ray imaging directly on operation table, basic laboratory biological examinations, diagnostic and treatment of patients.



MTN TECHNICAL DEVELOPMENT OFFICE

EMERGENCY CELL EXTENDED 10 FEET CONTAINER

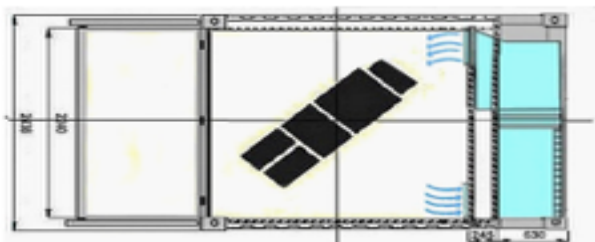

**ISO 668 / ISO 1 DD
SMM 110**

REGISTERED TRADE MARK
EMERCELL™

MTN EMERCELL is a mobile surgical workstation based on a ISO 1 DD steel container with innovative room extension trough patented coupling system, Optimized room surface equipped with all basic medical material and consumables for surgical emergency allows operations on site of the accident, riots, up to the civil war conditions. The **MTN EMERCELL** is the cheapest mobile surgical workplace designed especially for UN medical troops and for non governmental humanitarian help organizations (NGO)

"SMM means Surgical Modular Method of constructing mobile workplaces"

5/11/2017

MTN

25

Medical / Surgical or dental equipments of the operating theatre

See equipments inventory list

Consumables: Disposable syringes, Infusion Set, i.v. Cannula with Injection Valve & Wings (different color) and many consumable like compresses of gauze are in sufficient quantities for 24 hours are stored in drawers and cabinets near the operating table, stock quantities in transport boxes are ready to complete the materials for the next working day

Biochemical and hematology laboratory

This facility has a desk system with labor devices, a refrigerator of commercial type built in for transport purposes and a case and racks for storage of laboratory materials and sterilized surgical instruments. Equipped with standard analytic devices the laboratory assures all needed working procedures. The workstation contains the sterilization equipments too. Placed in the ISO 1 DD container the doctor's and assistant's preparing and washing room contains one wash basin, build in a furniture cabinet, one soap dispenser and one disinfection liquid dispenser. Adjacent to the washroom a small doctor's personal room and toilet in a small rest-room assures the personal need of the crew or as a patients ward

Power supplies and IT secured electrical cabinet installations for class 2 medical rooms - Example

Outside of the **ECU-MESorDRA** interior is placed in an machine bay one small vibration producing devices of nominally power 1 x 9 KW diesel-electric super silent generator in own sound shielded boxes, further the air conditioning, heating and filtering unit, an electric interface connection box is added to one of the medical containers. The power generator is wired with the **IT (Isolated Terra) secured electrical cabinet** for medical class 2 rooms with temperature and isolation monitored transformer. Connection box for public electric power supply system assure longtime functionality by semi-stationary use. The three sources are switched automatically trough a redundancy function of the IT secured electrical cabinet. This electric installation is an intelligent system of a safe and reliable IT (Isolated Terra) power supply and is compliant to the standard for medical power supplies for medical class II rooms (VDE0100 - part 710). The generator place is secured trough two wings anti-vandalism rugged doors.

IT secured electrical cabinet IMED with transformer



MTN™ MOBILE EXTENDED SURGICAL or DENTAL RESCUE ASSY is equipped with **IMED Secure®** power supply for group 2 medical rooms as operating areas or surgeries or dentals is an intelligent redundant system with isolation transformer and monitoring for a safe and reliable IT (Isolated Terra) power supply and is compliant to the standard for medical power supplies of class II rooms (**VDE0100 - part 710**)

ISOLATED TERRA SAFETY CABINET FOR GROUP 2 ROOMS IN ISO 668 MEDICAL CONTAINERS

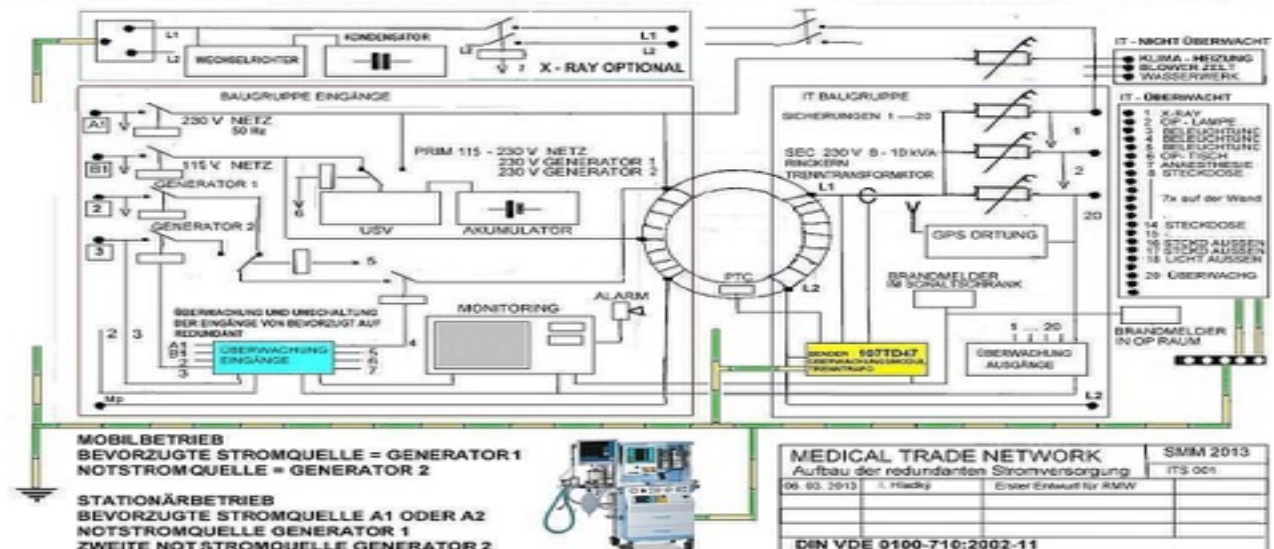

Water installation system

Under the generators place are three compartments with electric blower for inflating the tent, automatic water pump with air balloon and one accumulator of the generator. The water reservoir is placed in the first container and content 2 x 200 liters

Medical gases installation system

The medical gases box is placed in the first container and contents three pressure flasks with armatures

Detailed technical description of the ISO 1 DD container

General framework is welded, composed of

- steel sections
- 8 ISO corners (4 lower, 4 upper)
- steel trapezoidal plates = jacket of container

Note: All material used for container framework is certified by German Lloyd certification agency

Container is thermally insulated

The internal walls and the roof are isolated by panels composed of:

- coated 0,8 mm thick aluminum plates skin
- BASF polyurethane foam core
- panels are reinforced by steel inserts where necessary

Floor is also made of BASF polyurethane foam panels and plywood covered by a no slippery layer made of polyurethane coating

Container is equipped with stainless steel wall panel system

The wall system used in the construction containerized operating theatre is designed as a system of non-bearing partition walls and wall panels for interior use. With its structure, it meets all requirements imposed on quality, variability, physical properties and hygiene of operating theatres. Behind the panels are placed various equipments for electricity, medical gases and water distribution systems and the air ducting tubes of the air conditioning. The parameters of the wall system are designed and certified according to the following standards and procedures: Fire resistance (EN 13501-2). For a partition wall with a thickness of 200 mm, the fire resistance is 60 minutes Eccentric, horizontal load (ETAG 003:1998, ISO 7892-1988). The wall system (200 mm partition wall) is certified for an eccentric and horizontal load

Furniture for operating surgical or dental theatre

Interior layout of the ISO 1 DD 10' container can be personalised in compliance with the special technical requirement of customer

We will individually propose the best configuration of the special wood which is water protected furniture

Container and doors is equipped with single wing entrance door

The first container include one single entrance door. The second container include 3 single doors and the third container include one single door. The single side door on the second container can be tilted, provided installed in entrance door, equipped with cloth rubber sealing used for door sealing is rigid, elastic and resistant against erosion and sea water

Dimensions and weight

Container dimensions and weight comply with ISO 668 + Adm.1 norm
Further parameters comply with ISO 1496-1 + A1 and further ISO standards

External dimensions

Length 2.991 mm
Width 2.438 mm
Height 2.591 mm

Internal dimensions

Length 2.830 mm
Width 2.350 mm
Height 2.372 mm

Surface area in m² 6.66
Volume in m³ 15.9
Maximum gross mass approx. 5 000 Kg
Bare container weight approx. 955 Kg



CONTAINER DIMENSIONS OVERVIEW

ISO 668 CONTAINER DIMENSIONS									
Container Designation	Length, L			Width, W			Height, H		
	Tol		Tol	Tol		Tol	Tol		Tol
	MM	FT / IN	IN	MM	FT	IN	MM	FT / IN	IN
1CC	6058	0 19	0	2438	0 8	0	2591	0 8	0
1C	-5	10 1/2	-1/4	-5	-3/16	-3/16	-5	6(2)	-3/16
1D	2991	9 3/4	0	2438	0 8	0	2438	8	0
1 DD	-5	-3/16	-3/16	-5	-3/16	-3/16	2591	8	0
							-5	-3/16	-3/16



ISO 1 D



ISO 1 C

Safe mechanical environment

Container is labeled with CSC label according to regulation ISO 668. Container withstands forces generated during road, railroad and waterway transport

Container stacking

The manufacturer allows to stock up to 3 fully loaded containers on each other. The container must be safely secured under ISO 668, ISO 9000 : 2001, EN ISO 9000 : 2000, ISO 1496 forklift rails, ISO 1161 corner fittings 6058. The container is classified as special construction and connection

Container handling

Container is handled in compliance with regulation ISO 668. Container can be handled:

By hoisting the upper or lower ISO corners with a lifting device (for example: container side mover on TATRA chassis 8 x 8.2 as well as on VOLVO 8 x 4 with handling system KLAUS)

Operational climatic conditions

Container is fully operational in macroclimatic area N14 (SN 038206) norm

- a temperature ranging from - 32 °C to + 49 °C
- a relative air humidity of up to 90 % at a temperature of + 30 °C
- an air flow speed of up to 20 m / s - 1 in all wind directions
- a rainfall of 3 mm at an angle of incidence of 30 °C in all directions



Example of rear view into the ISO 1 DD 10' container

Detailed information of standards conformity

MTN™ EMERGENCY CELL UNIT ISO 1 DD - MOBILE EXTENDED SURGICAL or DENTAL RESCUE ASSY IN 3 CONTAINERS

Project code: SMM 110 EC ECU-MESorDRA	Customizable on customer's request
ISO 1 DD 10' container	
Issued January 16, 2017	
<u>External dimensions</u> Length 2.991 mm Width 2.438 mm Height 2.591 mm	The MOBILE EXTENDED SURGICAL or DENTAL RESCUE ASSY is composed of three ISO 1 DD 10' containers



ISO 1496 forklift rails
ISO 1161 corner fittings
CSC plated
NCAGE



(NATO Commercial and Governmental Entity Code)
EN ISO 9001 : 2001 / EN ISO 9001 : 2000
(Management based on ISO 9001:2001 applied in the production)

Pictured documentation



MOBILE EXTENDED SURGICAL or DENTAL RESCUE ASSY - CONTAINERS EXAMPLE ISO 1 DD 10' containers

Diesel electric generator

The external autonomous power supply system as a multivoltage and frequency 50 / 60 Hz adjustable silent diesel-electric aggregates switched from factory on 230 Volt 50 Hz (alternatively customizable on other tensions)

Outside of the **ECU-MESorDRA** interior are placed the small vibration producing devices, nominally the one power 9 KWh diesel-electric super silent generator in own sound shielded box, further the air conditioning and filtering unit, an electric interface connection box is added to each medical container parallel to the power generator. Connection box for electric power public supply system assure longtime functionality by semi-stationary use

Generator Set

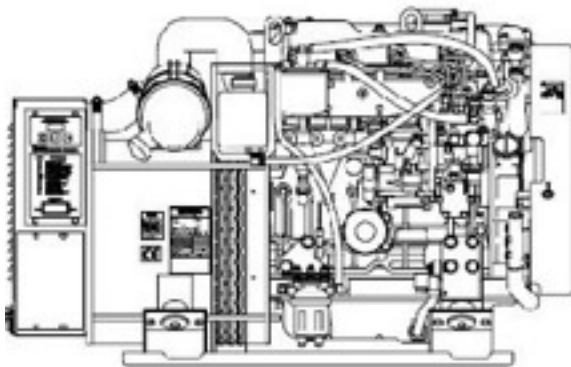

Engine Features

- Diesel fueled
- Four cylinder
- Four cycle
- Closed cooling system
- Heat exchanger
- Lifting eyes
- Electric fuel lift pump

Generator Features

- Remote start 12-pin connector
- Class H insulation
- Multivoltage adjustability
- 60/50 Hz capability
- Voltage regulation of $\pm 1.5\%$
- Radio suppression

Generator Weights and Dimensions

	Without Sound Shield	With Sound Shield
Weight, kg (lbs.)		
wet	347 (765)	382 (845)
dry	340 (750)	375 (830)
Length, mm (in.)		
12 volt	1042 (41.02)	1137 (44.75)
24 volt	1055 (41.52)	1137 (44.75)
Width, mm (in.)	563 (22.17)	635 (25.00)
Height, mm (in.)	658 (25.90)	690 (27.18)

Generator Ratings

Model Series	Voltage	Hz	25°C (77°F)	25°C (77°F)	Ph
			Amps	kW/kVA	
20EQZD	120/240	60	166.6/83.3	20/20	1
	115/230	50	148/74	17/17	1
17EFOZD	230	50	74	17/17	1
	240	50	70.8	17/17	1

ADC 2100 Advanced Digital Control Features

- Designed for today's most sophisticated electronics
- Easy to read alpha-numeric display
- Compact, integrally mounted control
- Potted boards/sealed connectors for maximum corrosion protection
- SAF J1-1939 CANbus output
- Remote monitoring of up to 13 fault conditions
- Membrane keypad for configuration and adjustment
- Programmed crank cycle

Optional Accessories

- Sound shield
- Remote digital gauge
- Siphon break
- Circuit breakers

CE ISO 9001

Example of the diesel electric generator

Air conditioning and heating

Operational climatic and heating condition device

Container is fully operational in macroclimatic area N14 (SN 038206) standard

- a temperature ranging from - 32 °C to + 49 °C
- a relative air humidity of up to 90 % at a temperature of + 30 °C
- an air flow speed of up to 20 m / s - 1 in all wind directions
- a rainfall of 3 mm at an angle of incidence of 30 °C in all directions

Compact container air conditioning and heating units prove successful under the toughest operating conditions in climatically critical zones and serve to air condition of special containers. They are ready-to-connect compact push-in units, i.e. all components necessary for partial air conditioning are housed within it. An integrated weatherproof grill guarantees optimum protection of the unit. The variations in heating and cooling range lie between 2,5 KW and 7,2 KW nominally 7 KW

For temperature control, various designs are available. In the basic version a defect degree class N and an EMC protection according to EN 55022 class B VDE 0871, limit value class A is guaranteed. If required, the units are equipped with humidifier and air dryer and / or HF isolator. The tubes of the air ducting systems are placed on the left length side of the container between the wall and inside panel system, and connected with the laminar flow field and two air grills

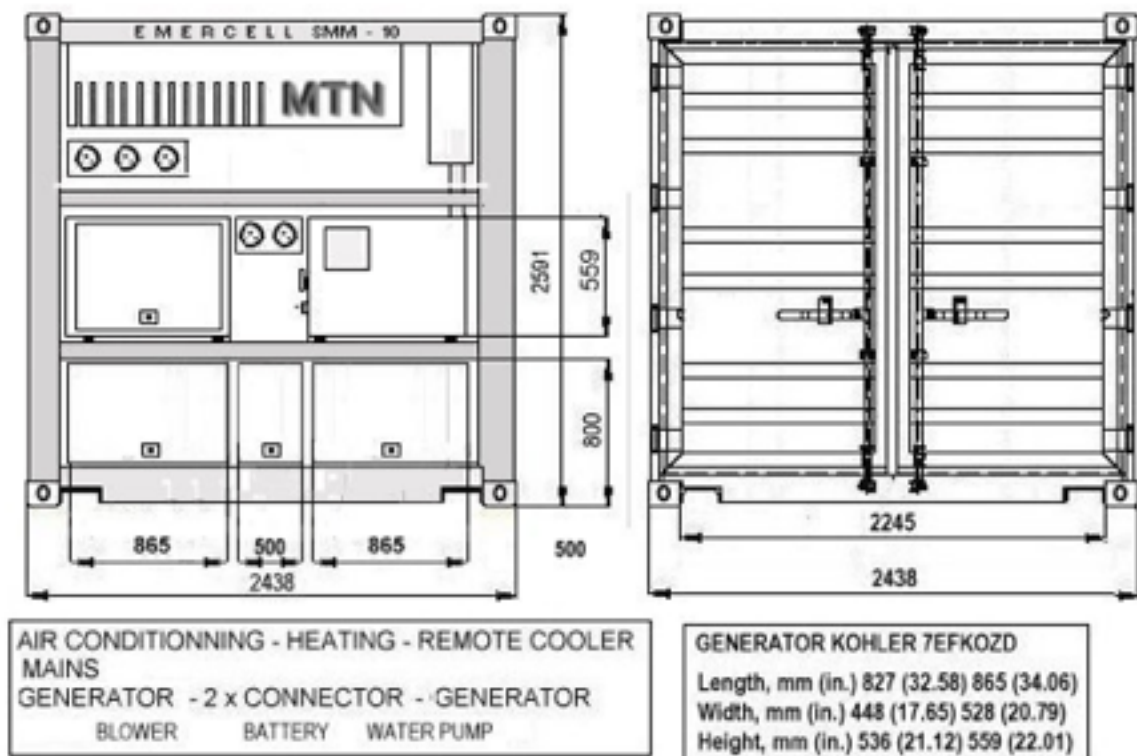

Schematic drawing of the machinery bay
Example for the diesel generator, optional can be from Kohler company

IMPORTANT NOTICE

- All technical data, dimensions, properties, standards, certifications, trade marks and product names of the ISO 1 DD containers and of the equipment corresponds to the last technical stand and they are one of more possible eventualities or solutions and can be changed or replaced, the offered product is customizable for the client's needs and specifications. The by the both sides approved ones are to be valid only after undersigning of the business agreement
- The electric equipment is standardized with nominal tension 230 V 50 Hz, IT secured electrical cabinet with ring coil isolating transformer and monitoring is standardized 230 V 50 Hz (alternatively customized tensions on request)

Quotation

We are honored to submit quotation for **MOBILE EXTENDED SURGICAL or DENTAL RESCUE ASSY** in ISO 1 DD containers with thermal insulation, medical equipment, energetic bloc, wiring and interfaces. Containers are customizable and full equipped with medical devices for the task of a **MOBILE EXTENDED SURGICAL or DENTAL RESCUE ASSY**

ISO 1 DD containers with thermal insulation - MOBILE EXTENDED SURGICAL or DENTAL RESCUE ASSY

Generally

The containers are based on standard ISO 1 DD steel construction with additional internal thermal insulation and additional door integration. Internal container area can subdivided into 2 compartments - **MOBILE EXTENDED SURGICAL or DENTAL RESCUE ASSY**

Construction material

- The container structure is made of welded steel profiles - steel S235 JRH is used
- ISO corners (8 pieces) comply with ISO 668 made of steel alloy (JIS G 5102 SCW 480)
- Pockets for forklift handling are integrated into container bottom frame
- Walls and roof is made of trapezoidal steel sheet (thickness 2 mm)
- Insulation for ceiling and walls is made of 40 mm sandwich panel for walls and ceiling assembled on the inside of the container. These panels are made of aluminum skins (thickness 0,8 mm) and polyurethane foam core (density 65 g / dm³). Reinforcement inserts can be integrated inside the panels where requested
- Insulation for the floor is made of 50 mm sandwich panel. These panels are made of one aluminum skin (thickness 0,8 mm), polyurethane foam core (density 65 g / dm³) and plywood (thickness 18 mm)
- The floor is covered by vinyl floor ALTRO finish
- Containers color schema -
 - The containers are painted on the outside with:
 - wash primer - S 2008 / 0600 thickness 10 µm
 - primer - S 2320 / 0600 thickness 33 µm
 - finish - polyurethane varnish U 2056 / 1000 thickness 2 x 30 µm
 - Walls and ceiling inside - polyester varnish HF 1F50 of ARCTIC WHITE color (code 966RB)

The container includes the following door, openings and interfaces

- Rubber seal used for door sealing is rigid, elastic and resistant against erosion and sea water
- The doors in log or weight side of container are integrated. See detailed technical description of the ISO 1 DD container points
- Input source box with trap door is integrated into technical compartment

The container includes the following equipments

- **MOBILE EXTENDED SURGICAL or DENTAL RESCUE ASSY** with all devices (see the inventory list)
- Furniture

- Energetic bloc with one 9 KW generator and IT secured Electrical Cabinet with ring coil isolating transformer and monitoring
- Switch box with connectors and grounding cable
- Water and waste tanks (2x) with plumbing components
- 3 Air-conditioning and optional ventilation device
- Electric network wiring

Operational climatic conditions

Container is fully operational in macroclimatic area N14 (SN 038206) standard

- a temperature ranging from - 32 °C to + 49 °C
- a relative air humidity of up to 90 % at a temperature of + 30 °C
- an air flow speed of up to 20 m / s - 1 in all wind directions
- a rainfall of 3 mm at an angle of incidence of 30 °C in all directions

Maintenance service and repairs of containers

Manufacturer ensures all repairs under guarantee, repairs, container inspections and container electrical installation inspections if required

Quality control and applied certifications

The manufacturer's production methods and quality control are certified and the products complies the certifications for maritime ISO containers, road, ship, train transport, including the compatibility with container manipulation devices and allows the certifications EN ISO 668, 9000:2001, EN ISO 9000:2000, ISO 1496 forklift rails, ISO 1161 corner fittings, CSC, IAF, NCAGE

Notice

All technical data, dimensions, properties, standards, trade marks and product names of the ISO 1 DD containers and of the equipment corresponds to the last technical stand and they are one of more possible customizable eventualities or solutions and can be changed or replaced without notice. The by the both sides approved ones are to be valid only after undersigning of the business agreement

Project equipment inventory

A	Non medical and medical equipments		
N o.	Items	Type	Pcs
1	Generator diesel-electric nominally 230 V 50 Hz 9 KW (<u>alternatively customizable on other tensions</u>) (built outside)	Standard	1
2	IT Electric cabinet with transformer IMED Secure 8 KVA RT SS316 for the main container	Standard	1
3	Air conditioning for the 3 containers without ventilation system (ventilation system is optional)	Standard	Each 1 pc
4	Water tank (approx. 200 L) with air ballon, plumbing components, outgoing waste installation	Standard	2 tanks
5	Distribution network of electricity	Standard	
6	Fluorescent lights - tubes	Standard	3
7	Furniture, tables, boxes, patient's and doctor's seats	Standard	

8	Computer, printer, monitor and software installation	Standard	Each container 1 pc
9	Electric operation table: MTN 5250 1E		1
10	Portable LED operation light: MEOL LED 50A		1
11	Anesthesia device: MTN AM 852E		1
12	ECG machine: CC 1200A		1
13	Fingertip pulseoximeter: ZA5		2
14	Syringe pump: 500 II and Infusion stand		1
15	Suction unit: Mevacs M30		1
16	Ultrasound: JM 9168F Analogic		1
17	Automatic electrolyte analyzer: PEEA 170		1
18	Autoclave: JY12 and Sterilization containers for instruments		1, 3
19	Table metallic for instruments		1
20	Surgical or dental instruments and Consumable set	See list	Each 1 Set
21	Immobilization mattress: CR - 10004 / PU with accessories		1
22	Transport and infusion emergency bed (1 function): ZH 3L		1
23	Pharmacy refrigerator with solid door: LM - PE 109C		1
24	Germicide emitter: HM - Hyspray with HM - Hycontrol		1
25	Desinfection - and Soap liquid dispenser		Each container 1 pc
26	Fire extinguisher		3
27	Stairs, Wheel chairs and Waste containers		Each container 2, 2 and 3

B	Consumables		
N o.	Description	Set	Qty
1	One-way syringes 2 cm ² Luer	Set of 10 000 pcs	1
2	One-way syringes 5 cm ² Luer	Set of 10 000 pcs	1
3	One-way syringes 10 cm ² Luer	Set of 10 000 pcs	1
4	One-way syringes 20 cm ² Luer	Set of 10 000 pcs	1
5	Infusion set	Set of 1000 pcs	1
6	I.v. Cannula with Injection Valve & Wings (different color)	Set of 1000 pcs	1

Various components

Operating electric and manually table: MTN 5250 1 E



Main specifications

Construction made of cast iron, finished with epoxy powder coating. Base of table made of steel sheets, finished with epoxy powder coating. Mattress made of foam, with synthetic leather cover. Hi-Lo, lateral tilt, Trendelenburg & reverse Trendelenburg movements adjustable by electric. Motor (LINK), controlled by hand controller. Suitable for radiography (Thorax) use. Ob-Gyn chair position. Overall dimension = 1950 mm (L) x 780 mm (W) x 780 ~ 980 mm (H)

Table dimension = 1950 mm (L) x 500 mm (W)

Table elevation (Hi - Lo) = 780 mm (min) ~ 980 mm (max)

Seat tilting (Trendelenburg) = - 18° ~ 18° ± 2°

Lateral tilting = - 20° ~ 20°

Back raise tilting = 0° ~ 70°

Leg raise tilting = 0° ~ - 90° Headrest tilting = - 20° ~ 40°

Electric motor = 24 Volt DC motor

Controller = Handheld controller

Main power = 220 Volt AC / 50 Hz

Power consumption = 100 Watt

Lifting mechanism = Box structure

Maximum weight capacity = 200 Kg

Accessories

Arm rest (1 Pair)

Hand rest (1 Pair)

Shoulder support (1 Pair)

Lateral body support (1 Pair)

Knee crutches (1 Pair)

Anaesthetic screen frame (1 Unit)

Battery Back-Up (Optional)

Quality standards

ISO 9001 : 2000

EN ISO 13485 - Particular requirements for medical devices

EN 46001 : 1996 - Quality system for medical device

SNI / SII

Germicide emitter: HM - Hyspray and the HM - Hycontrol

A easy and rapid disinfection by air of rooms. HM - Hyspray is a pulverizing appliance by air which disinfects rapidly mobile hospital rooms and surfaces. The pulverization is mechanical (Venturi effect) which allows the spreading of even sized droplets. It disinfects surfaces and decontaminates rooms in record time

Technical informations

The HM - Hyspray is a lightweight, ergonomic device. It can disinfect volume of 5 m³ to 165 m³. The diffusion time is 11 min to 50 m³. Voltage 230 V or 115 V

Applications

Hyspray is applied for this mobile hospital

Characteristics

The HM - Hyspray concept permits a homogeneous disinfection of surfaces without corrosion. No humidity on treated surfaces. Ecological and environmentally friendly

Realized test: *Pseudomonas aeruginosa*, *Staphylococcus aureus*, *Escherichia coli*, *Aspergillus niger*, *Sporos des clostridium difficile*, *Penicillium SPP*, *Norovirus*, *Bacillus stearothermophilus*

In addition to the hydrogen peroxide which enables surface disinfection. A small amount of product is used 6,6 ml / m³ (economical). Digital programming volume of the work piece avoids overuse of product

For the safety of users, the HM - Hyspray device is triggered after 90 seconds. A ergonomic trolley transportation is included with the unit

Solution

- 1) HM - Hydrogen Peroxide solution: To clean and disinfect in one step all places
7 %, Neutral or apple, Chemical stability: 4 until 25 Grad, 1 or 5 L Bottles
- 2) HM - Hyodor spray: To fight and eliminate bad odors safely
Colorless-limpid, Neutral, Chemical stability: 0 until 50 Grad, 1 ml / m³, 1 L Bottle



Traceability of the procedure with specific device (HM - Hycontrol): HM - Hycontrol is a continuous detection of hydrogen peroxide in the atmosphere, room temperature and the duration of the pulverizing of H₂O₂

It can plot the efficiency for the disinfection and store 40 000 measures in archival forms an internet platform. The user can visualize in live the data collected via a computer

Technical informations

Measurement scale H₂O₂: 0 ppm á 400 / 1000 ppm

Resolution: 0,2 ppm

Humidity measurement: 0 until 100 %

Temperature measurement: Between 4 and 50 Grad

Functioning signal: Via LED and buzzer

Energy voltage: 110 / 230 V, 50 / 60 Hz

Consumption: 3 W in activity and 0,5 W in Stby

Rechargeable battery
Size: 200 x 200 x 114 ml
Weight: 2 Kg



Anaesthesia Machine: MTN AM 852E



Technical Parameters

LED display
with one low end vaporizer BE500 (unremovable)
without selectatec backbar
Patient type: Pediatric and adult
Ventilation mode: IPPV, MANUAL

Gas supply: Oxygen, N₂O
WX210 absorb circuit
internal battery
two drawer and accessories
Alarm: Airway pressure limit, power supply failure, battery low
O₂ flush system
PVC tube
AGSS
Yoke: N₂O
Mechanical PEEP
Silicone mask
AGSS
WX 350 absorb circuit
selectatec back bar with one position
BE700 mid-end vaporizer (removable)
BE800 high-end vaporizer (removable)

Portable LED operation light: MEOL LED 50A



Technical Parameters

700 LED head / 500 LED head
illuminance adjustable range : 25 % - 100 %
K Color Temperature : 4000 - 5000 K
CRI RA : 95 R9 : 90 R13 : 92
50 % Spot Diameter (D 50): 150 mm / 120 mm
10 % Spot Diameter (D 10): 280 mm / 230 mm
Illumination Depth: 120 cm
Ultraviolet light irradiance within 40 nm wave length: 0.002 W / M²
Temperature at surgeon's head: ≤ 1 °C
Focus mode: manual or electric (optional, but price is different)

Power Supply: 220 V, 50 Hz
Lamp Beads Power: 1 W * 60 N / 1 W * 45 N
Input Power: 85 W / 65 W
The Average Life Expectancy H Lamp Beads: 50,000 hours
Lowest installation height: 2.8 M

MEVACS suction unit: M 30



Main specifications

Three different modes of exhaustion allow utilization of special suction unit MEVACS MTN M 30 Drainage not only for thorax drainage but also for suction from respiratory apparatus. Very low noise level, continuous operation and monitoring vacuum meter ensure high quality performance of thorax drainage

Compact suction unit MEVACS MTN M 30 is used also during suction from respiratory apparatus. Simple control, high reliability and easy cleaning are the main advantages for application in hospitals, practice and households

Air-flow rate of the pump: 30 l / min

Vacuum: 0.82 kPa

Collection jars: 1 l, 2 l



Ultrasound: JM 9168 F Analogic

Features

1. Digital technology of micro-computer & digital scanning converter (DSC). Brief circuits with reliable performance
2. Dynamic frequency imaging, multistage focusing, aperture control
Multi - frequency & high sensitivity probe contributes to consistently, high resolution images
3. Applicable to abdominal, obstetrics, gynecological, urological and small parts diagnosis
4. Cine-loop & permanent image storage
5. Built-in color coding module & VGA outlet
6. Activated hospital information
7. User-friendly with one-touch keyboard & trackball operation
8. USB 2.0 interface for image transferring

Specifications

1. Display modes: B, B + B, B + M, M
2. Scanner depth: 220 mm
3. Gray scale: 256
4. Image magnification: x 1.0, x 1.2, x 1.5, x 2.0
5. Cine-loop: Maximum 206 frames
6. Permanent image storage: 32 Frames
7. Image conversion: Up / down, left / right, black / white
8. Local zoom: 2 (can be used at frozen / real-time)
9. Frame correlation: Selectable 3 levels
10. Depth shift: B, B + B, real time shift
11. Resolution: lateral = 2 mm, axial = 1 mm
12. Body marks: = 10
13. Pseudo color processor: 7 Colors
14. Video output: PAL-D, VGA
15. Monitor: 7 / 10 Inches high resolution CRT
16. Measurement: Distance, circumference, area, volume, heart rate, pregnant week, fetal weight, EDD
17. Comments: Real-time, clock, date, scanning depth, model of probe, parameter of frame correlation, combination of focus, patient ID, gender, age, etc.
18. Power: consumption: 45 VA (standard)
19. 90 VA (with all options)
20. Power supply: 220 V \pm 10 % 50 Hz, 110 V \pm 10 % 60 Hz
21. Gross weight: 12.5 Kg
22. Net weight: 10 Kg (including probe)
23. Carton size: 43 * 42 * 40 mm
24. Probe: 2.5 / 3.5 / 5.0 Multi frequency convex linear array probe (standard)
25. 5.0 / 7.5 MHz Multi-frequency linear array probe (option)
26. 5.0 / 6.5 MHz Multi-frequency convex transvaginal probe (option for CUS-9618 F only)

Various components

Transport and infusion emergency bed (1 function): ZH 3 L

It is made of high-strength aluminum alloy thick-wall pipe. The surface can be separated from the bed, and it can be used as a stretcher. Furthermore, the head part can be raised up to 60°. The emergency bed is used for carrying patients and the wounded people for the hospitals, emergency centers and gymnasiums. It is specially suit to send the operated patients from operating room to sickroom. It's characterized by its being light, durable, antiseptic and easy for sterilization



Technical features

- 1) Product size (L x W x H): 190 x 55 x 88 cm
- 2) Maximum back angle: 60°
- 3) Packing size: 195 x 62 x 34 cm
- 4) N.W. 35 Kg
- 5) G.W. 41 Kg
- 6) Load bearing: Less than 159 Kg

Immobilization mattress: CR - 10004 / PU



CR - 10004 / PU - Anatomic vacuum mattress no compression 110 x 220 cm with tissu to protect, 8 ergonomic handles under the mattress, 3 straps to fixed the patient, Tissu polyurethan, Valve $\frac{1}{4}$ turning, x-Ray transluce, Easy cleaning and decontaminated

ECG machine: CC 1200 A

MTN CC 1200 A, with 8.4 inch color TFT 12 leads acquisition simultaneously. Touch screen and hiding handle, easy for movement. RJ 45 and RS-232 interface for data transmission to PC. USB interface for patient records transmission



www.medical-trade.net

Features

Automatic adjustment of baseline. Optional selections for rhythm lead

8.4 inch high-resolution color folding up touch-screen

AC / DC power supply built-in rechargeable li-ion battery

Single button operation

Sleep / wake up mode for saving energy and extending LCD life

Freeze real time waveform and record with selected format

Last 120 seconds waveforms reviewable and recordable

Printing preview of waveforms and auto-diagnosis result

Various printing formats

Complete digital filter, Avoid baseline drift, AC. EMG interference

Automatically detect and record arrhythmia

Internal storage for up to 300 digital ECG records

Support all the ECG rolling paper, folded paper and A 4 paper

External printer support and USB socket for data transmission

122 Kinds of arrhythmia analysis

Specifications

Lead: Standard 12 leads

Gain: 2.5 mm / mV, 5 mm / mV, 10 mm / mV, AGC (automatic), 20 mm / mV, 10 / 5 mm / mV, 20 / 10 mm / mV (classification, front means lead gain, behind means chest lead gain), accuracy $\pm 2\%$

Filter: (1) AC Filter: (2) EMC Filter: (3) Drift Filter: (4) Lowerpass Filter

Calibration voltage 1 mV $\pm 1\%$

Noise level: $< 15 \mu V_p - p$

Frequency response: 0.05 Hz - 150 Hz

Time constant: ≥ 5 s

Input impedance: 50 M Ω

Input circuit current: < 50 nA

Tolerance voltage: ± 650 mV

CMRR: ≥ 105 dB

Anti baseline drift: Automatic

External input / output: Input ≥ 100 K Ω , Sensitivity 10 mm / V ± 5 %. Output: ≤ 100 Ω , Sensitivity 1 V / mV ± 5 %

Communication interface: Ethernet, RS 232, USB

Recording system: 210 mm, 216 mm width thermal printer papers

Rhythm lead: Single channel and three channels selectable. 12 Leads selection for each channel.

Recording mode: Auto / Manual / Rhythm

Recording format: 12 x 1, 3 x 4, 6 x 2

Average template: 4 x 3 + 1 R, 6 x 2 + 1R recording

Record speed: 5 mm / s, 10 mm / s, 12.5 mm / s, 25 mm / s, 50 mm / s

Record paper: Roller and Z-fold

Safety standard: I, CF type

Memory: 300 ECGs, Built in 2G SD card to support over 10000 ECG records

Fingertip pulsoximeter: ZA 5



1. Two color OLED display, four display modes
2. No key press design, autoinduction for ON / OFF
3. 4-Direction display automatically
4. Visual alarm function. Real-time spot-checks
5. Low power consumption, 50 hours continuous to work
6. Low perfusion ≤ 0.4 %
7. Low voltage indicator
8. Automatic power off when no signal
9. Reliable accuracy and durability
10. Small and light weight, convenient to carry

Medical Trade Network



MTN ZA 5'S Highlights

- ◇ No key design.
- ◇ Automatic power on and off
- ◇ Varietal color for your option
- ◇ Patent 4 direction auto-orientation
- ◇ (Green, Pink, Royal blue and Black)

Syringe pump: 500 II



Function and features

- Three operation modes: Rate mode, Time mode, Body Weight mode
- Double CPU, making the process of injection safer and more reliable
- Accurate and sensitive pressure sensor detecting occlusion pressure accurately
- Injection time, dose, solution can be checked during the process of injection
- Precision step motor. There is no pulsating wave even during low-rate injection
- KVO rate can be selectable according to concrete requirements from 0.1 ml / h - 5 ml / h
- Excellent injection operation. The accuracy will be ensured even at small-volume injection
- Unique injection supervision system ensures the safe injection and reduces the nurse's workload
- Accept all standard syringes of 5 ml, 10 ml, 20 ml, 30 ml and 50 ml. It will self-diagnose and display the syringe size and set parameter automatically in the form of menu
- Alarm is given when there is malfunction or operation error, and the machine stops running automatically
- Preset volume can be automatically selected when there is unpredictable switch-off, thus ensuring the accuracy of injection volume

Laboratory equipments

Electrolytic analyzer: PEEA 170



Features

Large LCD display

Using of standard automatic tracking software, failure automatic alarm

Automatic selection, automatic calibration, fast analysis speed

Fully enclosed reagent pipeline, can avoid any contamination

Auto maintenance function simple operation

Controlling calibration procedure, auto calibrate the measurement data

power-off protection, Large memory for 1000 results

Auto sleep and awake function

Advanced Tco 2 sensor, reliable and clear results

Specifications

Measurement techniques: ISE direct method

Testing items: Free selection K, Na, Cl, Ca, PH Tco2, AG

Testing sample: Serum, plasma, whole blood, diluted urine, nurolymph

Sample usage: 60 ul - 300 ul (3 Items-10 items)

Controlling mode: Standard mode

Testing speed: ≤ 25 s

Testing range and accuracy

		Testing range	Resolution	Testing accuracy (CV)
K+	0.5 - 20.0 mmol / l	0.01 mmol / l	≤ 1.0 %	
Na+	15 - 200 mmol / l	0.1 mmol / l	≤ 1.0 %	
Cl-	15 - 200 mmol / l	0.1 mmol / l	≤ 1.0 %	
Ca+ +	0.1 - 6.0 mmol / l	0.01 mmol / l	≤ 1.0 %	
PH	4 ~ 9 PH	0.01 PH	≤ 0.5 %	
Tco2	2.0 - 70.0 mmol /	0.1 mmol / l	≤ 3.0 %	

Interface RS 232

Printer built-in thermal printer

Working environment: Temperature 5 ~ 35 Humidity: 10 % - 90 %

Power supply: 100 - 240 V 50 Hz

Autoclave: JY 12



Sterilizes and sanitizes miscellaneous packed or unpacked medical instruments, whether solid or A-type hollow, whether with B-type hollow and B-type hollow multi-apertures or inset pipes. It efficiently rids air from every hollow area of any hollow instrument, such as hand piece, making sure that water steam reaches every corner

Double-controlled door lock, Pressure accuracy 0.1 bar, LED Display, Volume of the chamber: 12 L

Instruments list

Item	Description	Quantity	Size	MTN No.
Mac-Intosh Laryngoscopes and accessories	Laryngoscope handle for adult M - 02 - 002, standard illumination manufactured from stainless steel. ANSI 304	5	Size 2, 100 mm, 78 mm, 17 mm	02 - 006
		5	Size 3, 130 mm, 108 mm, 18 mm	02 - 007
		5	Size 4, 155 mm, 133 mm, 18 mm	02 - 008
		5	N4, 8 mm, 65 mm, MS	17 - 022
Tracheal Tubes	Outer and inner tube closed	5		
Tuning Forks	From MTN 24 -151 C 128 until MTN 24 - 156 C5 4096			
Mallets	Mallets	1	20 mm, 150 g, 16,5 cm	792 - 398
	Collin	1	30 mm, 220 g, 20 cm	792 - 396
Scalpel Handles	Sterile with metal handle	50		792 - 001
			Fig 10	792 - 005
			Fig 11	792 - 006
	Cartilage knives, with wooden handle	50	31 cm, 12 ¼	01 - 015
	Amputation knives, with hollow handle	20	29 cm, 11 ½, 160 mm	01 - 056
		20	32,5 cm, 12 ¾, 190 mm	01 - 057
	Resection knives, solide handle, dissecting end, Langenbeck	50	18 cm, 7, 55 mm	01 - 060

	Dissecting knives, with metal handle	20	From Fig. 1, 30 mm, S 01 - 001 until Fig 5, 50 mm, S 01 - 005 From Fig. 6, 27 mm, S 01 - 006 until Fig 10, 50 mm, S 01 - 010 With Scalpel Handles - solid No. 3, 12 cm, S 01 - 030 and Fig. 10 - 17 As disposable Scalpels - sterile, single packed, packed with 10 units Fig. 10, S 01 - 049 Fig. 12 D, S 01 - 054	
Scissors	Operating scissors	5	13 cm, 5	02 - 002
			14,5 cm, 5 $\frac{3}{4}$	02 - 003
			18,5 cm, 7 $\frac{1}{4}$	02 - 005
			20,5 cm, 8	02 - 006
			14,5 cm, 5 $\frac{3}{4}$	02 - 009
			20,5 cm, 8	02 - 012
			13 cm, 5	02 - 018
			14,5 cm, 5 $\frac{3}{4}$	02 - 019
			18,5 cm, 6 $\frac{1}{2}$	02 - 021
			20,5 cm, 8	02 - 022
			14,5 cm, 5 $\frac{3}{4}$	02 - 034
			14,5 cm, 5 $\frac{3}{4}$	02 - 035
			14,5 cm, 5 $\frac{3}{4}$	02 - 037
			14,5 cm, 5 $\frac{3}{4}$	02 - 038
	Dissecting scissors	5	15 cm, 6	02 - 053
			17 cm, 8 $\frac{3}{4}$	02 - 054
			15 cm, 6	02 - 055
			17 cm, 8 $\frac{3}{4}$	02 - 056
			18 cm, 7	02 - 087
			20,5 cm, 8	02 - 088
			23 cm, 9	02 - 089

			26 cm, 10 ¼	02 - 090
			28,5 cm, 11 ¾	02 - 091
			31 cm, 12 ¼	02 - 092
			TC-Gold scissors with tungsten carbide inserts. welded tungsten carbide cutting edge, therefore no seam tending to corrosion. Golden rings for easy identification.	
	Operating scissors	10	14,5 cm 5 ¾	03 - 002
			14,5 cm 5 ¾	03 - 003
			14,5 cm 5 ¾	03 - 005
			14,5 cm 5 ¾	03 - 006
	Dissecting scissors, Mayo-Stille	10	14,5 cm 5 ¾	03 - 021
			14,5 cm, 6 ¾	03 - 022
			14,5 cm, 5 ¾	03 - 023
			17 cm, 6 ¾	03 - 024
Forceps	Wire and crown Ligature and bandage scissors universal	10	14 cm	792 - 079
			18 cm	792 - 080
	Bandage scissor lister, lister-TC-Gold	5	18 cm, 7	12 - 016
			16 cm, 6 ¼	12 - 007
			19 cm, 7 ½	12 - 008
	Dressing forceps, standard pattern	20	14,5 cm, 5 ¾	04 - 004
			16 cm, 6 ¼	04 - 005
			25 cm, 9 ¾	04 - 009
			30,5 cm, 12	04 - 010
	Ulrich	10	From S 06 001, 22,5cm, until S 06 - 002, 26,5cm	

		From S 06 - 003, 22,5 cm until S 06 - 004, 26,5 cm	
Gross-Maier	10	S 06 - 010, 20,5 cm until S 06 - 015, 26,cm	
Dissecting forceps, standard pattern	10	14,5 cm, 5 $\frac{3}{4}$	04 - 089
		16 cm, 6 $\frac{1}{4}$	04 - 090
		25 cm, 9 $\frac{3}{4}$	04 - 094
		30 cm, 12	04 - 095
TC-Gold, normal profile	20	17,5 cm, 7	04 - 041
		17,5 cm, 7	04 - 042
Haemostatic forceps, spencer wells	10	14 cm, 5 $\frac{1}{2}$	05 - 065
		15 cm, 6	05 - 066
		18 cm, 7	05 - 067
		20 cm, 8	05 - 068
Atrauma organ grasping forceps	20	25 cm, 9 $\frac{3}{4}$	05 - 071
		26 cm, 10 $\frac{1}{4}$	05 - 072
Dissecting and ligature forceps, Overholt-Martin	10	Fig 1, 18,5 cm, 7 $\frac{3}{4}$	05 - 212
		Fig 2, 20,5 cm, 8	05 - 213
		Fig 3, 21 cm, 8 $\frac{1}{4}$	05 - 214
		Fig 4, 21,5 cm, 8 $\frac{1}{2}$	05 - 215
		Fig 5, 24,5 cm, 9 $\frac{3}{4}$	05 - 216
Rumel	10	24 cm, 9 $\frac{1}{2}$	05 - 265
		23,5 cm, 9 $\frac{1}{4}$	05 - 266
		23 cm, 9	05 - 267

		24 cm, 9 ½	05 - 268
		23,5 cm, 9 ¾	05 - 269
Peritoneum forceps, Mikulicz			
	10	20 cm, 8	05 - 334
		20,5 cm, 8	05 - 335
Dressing forceps, Ulrich			
	10	22,5 cm, 8 ¾	06 - 001
		26,5 cm, 10 ½	06 - 002
		22, 5 cm, 8 ¾	06 - 003
		26,5 cm, 10 ½	06 - 004
Gross-Maier			
	10	20,5 cm, 8	06 - 010
		22 cm, 8 ¾	06 - 011
		26,5 cm, 10 ½	06 - 012
		20 cm, 8	06 - 013
		21,5 cm, 8 ½	06 - 014
		26 cm, 10 ¼	06 - 015
Sponge forceps, foerster			
Smooth jaw	10	25 cm, 9 ¾	06 - 020
		24,5 cm, 9 ¾	06 - 024
Tissue and atraumatic vascular forceps			
Cushing	10	18 cm	792 - 124
DeBakey	10	15 cm	792 - 131
			792 - 132
Adson, 12 cm	10	MTN 792 - 118	792 - 119
Adson Brown	10	MTN 792 - 120	792 - 121
Intestinal and tissue grasping forceps			
Duval	10	20,5 cm, 8	19 - 020
Nasal specula	5		

Retractors and Self-Retaining

Killian	10	From MTN 25 - 010, 13 cm, 5, Fig. 1 until MTN 25 - 013, 13 cm, 5 Fig. 4	
Killian forceps	10	16 cm, 6 ¼	25 - 030
Roux	10	Fig 1 = 24 x 20 mm, 29 x 26 mm, 35 x 29 mm, 30 x 28 mm, 36 x 36 mm, 38 x 43 mm	
		10 mm	792 - 309
		20 mm	792 - 310
		From MTN 07 - 305, 17 cm, 6 ¾, Fig. 1-3 until	
		17 cm, 6 ¾	07 - 308
Weilaner			
	10	Sharp, 10,5	792 - 316
		Blunt	792 - 316
Retractors			
	5	25 x 7 mm	792 - 291
		35 x 10 mm	
		42 x 11 mm	
		55 x 12 mm	
		70 x 14 mm	
		80 x 16 mm	792 - 296
Volkman, 21,5 cm, 8 ½			
	10	Sharp	07 - 104
			07 - 105
			07 - 106
			07 - 107
Volkman, 22 cm, 8 ¾	10		
Sharp, 21,5 cm, 8 ½	10		

Martin, 22,5 cm, 8 $\frac{3}{4}$	10	Sharp	07 - 142
			07 - 143
			07 - 144
Israel	10	Blunt, 25,5 cm, 10, 40 x 40 mm	07 - 154
		25,5 cm, 10, 45 x 50 mm	07 - 155
		25,5 cm, 10 x 50 x 60 mm	07 - 156
		25,5 cm, 10, 70 x 70mm	07 - 157
Langenbeck	10	From MTN 07 - 158 22,5 cm, 8 $\frac{3}{4}$, 30 x 11 mm until MTN 07 - 167, 22,5 cm, 8 $\frac{3}{4}$, 50 x 11 mm MTN 07 - 168, 21 cm, 8 $\frac{1}{4}$, 65 x 20 mm	
Kocher	10	From MTN 07 - 172, 23 cm, 9, 43 x 18 mm until MTN 07 - 176, 23 cm, 9 cm, 78 x 40 mm	
Kocher-Langenbeck	10	From MTN 07 - 199, 25 cm, 8 $\frac{1}{2}$, 22 x 12 mm until MTN 07 - 203, 23 cm, 9 cm, 43 x 20 mm	

	10	From MTN 07 - 186, 21, 5 cm, 8 ½ , 25 x 10 mm until MTN 07 - 193, 21,5 cm, 8 ½ , 85 x 25 mm	
Fritsch			
	10	From MTN 07 - 226, 23, 5 cm, 9 ¼ , 37 x 31 mm until MTN 07 - 231, 26,5 cm, 10 ½ , 65 x 85 mm	
Coryllos			
	10	From MTN 07 - 24 cm, 9 ½ , 108 x 43 mm until MTN 07 - 242, 24 cm, 9 ½ , 119 x 65 mm	
Brunner			
	10	From MTN 07 - 253, 25, 5 cm, 10, 182 x 30 mm until MTN 07 - 258, 25,5 cm, 10, 82 x 20 mm	
Abdominal spatulas, kader			
	10	From MTN 07 - 302, 28 cm, 11, 20 mm until MTN 07 - 304, 28 cm, 11, 40 mm	
Wound spreaders, self-retaining, weitlaner, 20 cm, 8			
	10	Sharp	07 - 338
		Blunt	07 - 340
Vickers, blunt, ring model, for thumb and fingers	20	5 cm, 2	07 - 405
Abdominal retractor complete with 1 pair of lateral blades and central blade	5 Set	From MTN 07 - 415 until MTN 07 - 418	

Needle Holders	Kirschner	10	240 x 240	07 - 469
			40 x 55	07 - 470
			50 x 65	07 - 471
	Flexible	10	MTN 792 - 250 until MTN 792 - 255	
	Micro hooklets, skin hooks			
	O'Connor, 16 cm, 6 ¼	10	Sharp	07 - 015
	Guthrie, 15,5 cm, 6	10	Sharp	07 - 016
				07 - 017
			Blunt	07 - 024
				07 - 025
	Saddle hooks			
	Desmarres, 16 cm, 6 ¼			
		10	16 cm, 6 ¼ , 8 mm	07 - 035
			16 cm, 6 ¼ , 10 mm	07 - 036
			16 cm, 6 ¼ , 12 mm	07 - 037
			16 cm, 6 ¼ , 14 mm	07 - 038
			16 cm, 6 ¼ , 16 mm	07 - 039
			16 cm, 6 ¼ , 18 mm	07 - 040
Needle Holders	Lichtenberg	20	17 cm	792 - 237
	Mayo-Hegar	10	From MTN 10 - 086, 14, 5 cm, 5 ¾ until MTN 10 - 092, 30,5 cm, 12	
	Hegar-Baumgartner, TC- Gold	20	13 cm, 5 as mini pro- file	11 - 045
			14,5 cm, 5 ¾ as mini profile	11 - 046
	Mayo-Hegar, TC-Gold	10	From MTN 11 - 055, 16 cm, 6 ¼ until MTN 11 -063, 30 cm, 11 ¾	
	Masson-TC-Gold	10	26,5 cm, 10 ½ as standard profile	11 - 075
	Lichtenberg-TC-Gold	10	20 cm, 8 as normal- profile	11 - 127

Bone Instruments	Deschamps		
	10	20 cm, 8	11 - 165
		20 cm, 8	11 - 166
		24 cm, 9 ½	11 - 157
		24 cm, 9 ½	11 - 158
		27 cm, 10 ½	11 - 167
		27 cm, 10 ½	11 - 168
	Overholt-Geissendoerfer		
	10	Fig 1, 19 cm	792 - 190
		Fig 2, 20,5 cm	792 - 191
	10	Haemostatic forceps, Hartmann 10 cm, Straight	792 - 160
	Plaster shears, Stille Martin		
	10	23 cm, 9 as Spare Blade	12 - 010
		27 cm, 10 ¾ as Spare Blade	12 - 011
	10	Plaster-spreaders, Wolff From MTN 12 - 026, 18 cm, 7 MTN 12 - 027, 26,5 cm, 10 ½	
	5	Amputation saw, charriere 35 cm	S 13 - 001
	5	Spare saw blades, charriere	S 13 - 002 until S 13 - 004
	Extension bows		
	Kirschner with 3 tractions hooks From MTN 13 - 178, 95 x 70 mm until MTN 13 - 182, 200 x 155 mm		
	5	18,5 cm, 7 ¼ as Wire Strainer	13 - 177
		20 cm, 8 as Wrench	13 - 185
	5	Combi-flat nose plier with parallel grip 18 cm, 7	13 - 137
		17,5 cm, 7	13 - 144

Wire cutting pliers for soft wire	5	17 cm, 6 $\frac{3}{4}$	13 - 151
Soft bone wire	10	10 m	From MTN 13 -161, 0,8 mm until MTN 13 -165, 1,5 mm
Loute	5	21 cm, 8 $\frac{1}{4}$	13 - 169
Chisel, osteotomes, gouges, stille	5	From MTN 14 - 068, 20 cm, 8 until MTN 14 - 077, 20 cm, 8	
Lexer	5	From MTN 14 - 110, 22 cm, 8 $\frac{3}{4}$ until MTN 14 -121, 22 cm, 8 $\frac{3}{4}$	
Bone rasps	5	Putti, 27 cm, 10 $\frac{3}{4}$	14 - 204
		Semi round, 24,5 cm, 9 $\frac{3}{4}$	14 - 414
Bone curettes, Volk-mann, oval with plastic handle	10	From Fig.1 MTN 14 - 242, 18,5 cm, 7 $\frac{3}{4}$ until Fig. 3 MTN 14 - 252, 27,5 cm, 10 $\frac{3}{4}$	
Hohmannn, narrow tipp	10	From MTN 14 - 451, 22 cm, 8 $\frac{3}{4}$ until MTN 14 - 454, 25 cm, 9 $\frac{3}{4}$	
Wide tip with groove	10	From MTN 14 - 455, 23, 5 cm, 9 $\frac{3}{4}$ until MTN 14 - 458, 27,5 cm, 10 $\frac{3}{4}$	
Bone rongeurs			
Freidmann	5	13,5 cm, 5 $\frac{3}{4}$	14 - 543
Zaufal-Jansen	5	18 cm, 7	14 - 563
Stille-luer	5	22,5 cm, 8 $\frac{3}{4}$	14 - 578
Bone cutting forceps			
Ruskin liston	5	18 cm, 7	14 - 600
		18 cm, 7	14 - 601
Bone rongeurs, multiple action			
Beyer	5	18	792 - 342
Cleveland 4 A	5	17	792 - 335

	Luer	5	15	792 - 340
	Bone curettes, Volk- mann			
		15	000	792 - 400
			Fig 0	792 - 402
			Fig 1	792 - 403
			Fig 2	792 - 404
			Fig 3	792 - 405
Clamps	Towel clamps, ueers- Bertram-Modif wide jaw for tube fixation	30	15,5 cm, 6	05 - 349
	Backhaus			
		30	9 cm, 3 ½	05 - 345
			11,5 cm, 4 ½	05 - 346
			13 cm, 5	05 - 347
			16 cm, 6 ¼	05 - 348
	Tubing clamps, extra long ratchet			
		30	14 cm, 5 ½	05 - 360
			16,5 cm, 6 ½	05 - 361
Sterilization and Con- servation				
	Konrich sterilizing drum, stainless steel			
		25	80 x 80	793 - 066
			120 x 120	793 - 068
	Lid with knob			
		25	165 x 85 x 35	793 - 038
			260 x 150 x 50	793 - 042
	Kidney tray	30	250 x 140 x 30	793 - 011
	Jar without lid			
		5	50 x 130	793 - 031
			75 x 175	793 - 035

Holloware (Stainless Steel Products)

Perforated tray	10	From MTN 01 - 001 20 x 10 x 14 cm until MTN 01 - 005, 40 x 20 x 5 cm	
Instrumental tray with lidd	20	From MTN 01 - 014, 10 x 15 x 2,5 cm until MTN 01 - 021, 23 x 15 x 5 cm	
Instrumental box w / books	20	From MTN 01 - 035, 17 x 7 x 3 cm until MTN 01 - 043, 50 x 20 x 12 cm	
Kidney tray shallow	15	From MTN 01 - 062, 17 cm until MTN 01 - 064, 24 cm	
Sterilizing drum	25	From MTN 01 - 081, 24 x 12 cm until MTN 01 - 091, 39 x 29 cm	
Wash basin	5	From MTN 01 - 111, 10 cm until MTN 01 - 113, 14 cm	
Dressing jar	5	From MTN 01 - 124, 3 x 3 until MTN 01 - 127, 6 x 6	
Cotton holder	15		01 - 173

Or the set of dental instruments

List of diagnostic and dental reason instruments for the MOBILE EXTENDED SURGICAL or DENTAL RESCUE ASSY. Autonomy ISO 1 DD 10' Container

The instruments understand each other instruments as one-way and increase-way for itself. The increase-way-instruments are intended because one will constantly use her/it/them, e.g. sterilization box for instruments that constantly are in use. .Some instruments, that frequently are used, should be made available as TC-Gold instruments. Before the business-start in the mobile hospital, shall sister as well as. Keepers the instruments divide into different steri-riddles and write on after corresponding sterilization. Our experiences yielded that an exact number is not possible at instruments because everyone is applied mobile unit differently

There is, something would distinguish everyone preferentially from instrument surgeon, e.g.: With use of needle-holder

Diagnostic Set

2,5 V Standard illumination for use with 2 batteries type C

Including:

Otoscope head: pin contact fitting, Chrome plated

Fix lens 4x in plastic mount may be removed for introducing of instruments

Reusable specula 1, 2 and 3 mm, included

May-Ophthalmoscope head: Pin contact fitting

Lens selection wheel permits choice of corrective lenses from 0 to + 20 and 0 to - 20 dioptries
 Single large circle overtube
 Bent-arm illuminator: Pin contact fitting
 Chrome plated. Tongue blade holder: Chrome plated
 Nasal speculum: Chrome plated
 Two laryngeal minors: n3 and 4
 Battery handle: 28 mm. For adjustment of illumination
 Replacement bulb: 2,5 V
 The diagnostic set is supplied in black plastic storage case

Items	Quantity	Description	Size	MTN
MC-Intosch Laryngoscopes and accessories,	5			
		Laryngoscope handle for adult M - 02 - 002, Standard illumination manufactured from stainless steel. AISI 304		
			2, 100 mm, 78 mm, 17 mm	02 - 006
			3, 130 mm, 108 mm, 18 mm	02 - 007
			4, 155 mm, 133 mm, 18 mm	02 - 008
Tracheal tubes	5	Outer and inner tube closed	N4, 8 mm, 65 mm, MS	17 - 022
Tuning forks	1	From MTN 24 - 151 C 128		Until MTN 24 - 156 C5 4096
Mallets	1	Mallets	20 mm, 150 g, 16,5 cm	792-398
		Collin	30 mm, 220 g, 20 cm,	792 - 396
Water and dental syringes	20	Cartridge syringes with the aspirating hooks and locking device	1,8 ml	792 - 502
	20	Pressure syringe for intra-ligamental anaesthesia	1,8 ml	792 - 505
Scalpel handles	30	Dissecting knives. As disposable Scalpels, sterile, single packed, packed with 10 units		
			FIG 10	S01 - 049
			FIG 12 D	S01 - 054
Dental instruments	30	Contouring pliers-Reynolds	13 cm	795 - 019
	30	Wire bending pliers-Adams	12,5 cm	795 - 011

	30	Flat nose pliers	14 cm	795 - 009
	30	Arch and spring bending pliers	13 cm	795 - 014
	30	Universal pliers-Weingart	14 cm	795 - 005
	20	Carving instruments-Hollenback		
				794 - 395
				794 - 396
				794 - 397
	20	Carving instruments-Hylin		
				794 - 403
				794 - 404
	20	ROOT canal instruments		
			Explorer	794 - 375
			Excavator	794 - 376
			Excavator	794 - 377
			Black	794 - 344
	20	Filling instruments-Dycal		
			SOS	794 - 254
			SOS	794 - 255
	20	Rotondo round handle		
				794 - 187
				794 - 188
				794 - 189
	10	Excavators		
				794 - 179
				794 - 182
	20	Gingival margin trimmers-Black		
			1,5 mm	794 - 140
			1,5 mm	794 - 141
	30	Complete set-dental		794 - 130
	30	universal cures		

			Mc call	794 - 097
			Younger Good	794 - 098
	30	Scalers-hygienist		794 - 059
Dental needle holders				
	10	Lichtenberg	17 cm	791 - 058
		Mathieu	14 cm	791 - 052
			17 cm	
	5		20 cm	791 - 054
	5	Mayo-Hegar	16 cm	791 - 033
			18 cm	
			20 cm	791 - 035
	10	Derf	12 cm	791 - 027
Siccors				
	5	Metzenbaum	14,5 cm, Curved	791 - 003
	5	Delicate	14,5 cm, Straight	791 - 001
				791 - 002
Operating sissors	30		13 cm, 5	02 - 002
			14,5 cm, 5 ¾	02 - 003
Dissecting sciccors	30		15 cm, 6	02 - 053
			15 cm, 6	02 - 055
Mouth mirror	10	Mega	All-Size	790 - 013
Extracting forceps	15	Lower incisor and roots	Fig 203	787 - 030
		Lower teeth for children	Fig 151 S, Cryer	787 - 029
		Lower incisor premolars, roots	Fig 103	787 - 024
		Upper centrals and canines	Fig 1	787 - 001
Forceps				
	20	Dressing forceps, standard pattern	14,5 cm, 5 ¾	04 - 004
			16 cm, 6 ¼	04 - 005

			25 cm, 9 $\frac{3}{4}$	04 - 009
			30,5 cm, 12	04 - 010
	20	Dissecting forceps, standard pattern		
			14,5 cm 5 $\frac{3}{4}$	04 - 089
			16 cm, 6 $\frac{1}{4}$	04 - 090
			25 cm, 9 $\frac{3}{4}$	04 - 094
	20	Langenbeck-Mini, 16 cm, 6 $\frac{1}{4}$		
			10 x 6 mm	07 - 045
			17 x 5 mm	07 - 046
			20 x 6 mm	07 - 047
			22 x 8 mm	07 - 048
		Micro hooklets, skin Hooks		
	10	O'Connor, 16 cm 6 $\frac{1}{4}$	Sharp	07 - 015
	10	Guthrie, 15,5 cm 6		
			Sharp	07 -016
				07 - 017
			Blunt	07 - 024
				07 - 025
		Saddle hooks		
	10	Desmarres, 16 cm 6 $\frac{1}{4}$	8 mm	07 - 035
			10 mm	07 - 036
			12 mm	07 - 037
Clamps		Towel clamps		
	5	Backhaus	9 cm, 3 $\frac{1}{2}$	05 - 345
			11,5 cm, 4 $\frac{1}{2}$	05 - 346
			13 cm, 5	05 - 347
			16 cm, 6 $\frac{1}{4}$	05 - 348
Sterilization and conservation				
	15	Konrich sterilizing drum stainless steel	80 x 80	793 - 066

			120 x 120	793 - 068
	15	Lid with knob	165 x 85 x 35	793 - 038
			260 x 150 x 50	793 - 042
	30	Kidney Tray	250 x 140 x 30	793 - 011
Holloware (stainless steel products)	5	Perforated tray from MTN 01 - 001 20 x 20 x 14 cm until MTN 01 - 005, 40 x 20 x 5 cm		
	5	Instrumental tray with lid from MTN 01 - 014, 10 x 15 x 2,5 cm until MTN 01 - 021, 23 x 15 x 5 cm		
	10	Instrumental box w / hooks from MTN 01 - 035 17 x 7 x 3 cm until MTN 01 - 043, 50 x 20 x 12 cm		
	10	Sterilizing drum from MTN 01 - 081, 24 x 12 cm until MTN 01 - 091, 39 x 29 cm		
	15	Wash basin from MTN 01 - 111, 10 cm until MTN 01 - 113, 14 cm		
	5	Dressing jar from MTN 01 - 124, 3 x 3 until MTN 01 - 127, 6 x 6		
	5	Cotton holder		01 - 173

Surgical dressing, combustion and scalding-material for 90 Days. MOBILE EXTENDED SURGICAL or DENTAL RESCUE ASSY. Autonomy ISO 1 DD 10' Container

No.	Description of the consumables list	MTN-No.	Dimension	90 days
1.0	Sterile lint-compresses of gauze DIN EN 14079, 17-fibred, all cut edges inside			
1.1		13600	5 x 5 cm	250
1.2		13602	10 x 10 cm	250
1.3		13603	10 x 20 cm	250
1.4		13695	5 x 5 cm	250
1.5		13697	10 x 10 cm	250
1.6		13699	10 x 20 cm	250
2.0	Sterile lint-compresses 8-times put and especially suction-strong			

2.1		40646	5 x 5 cm	250
2.2		40649	10 x 10 cm	250
3.0	Sterile combustion-compresses of more-layer-y special-association-material, therefore consist of three layers from vacuum- aluminization, voluminous and needled fleece-material. Packs individually in the donor-carton			
3.1		23082	10 x 12 cm	250
3.2		23087	10 x 20 cm	250
4.0	Sterile hydro-gel compresses to the support of the wound-cleaning and cure with superficial necrotic wounds, combustions 2. Degree. The sore-page found, hydrophilic gel-layer nestles up well, moisture hands over at the wound, ideal moist milieu manages, the necrotic wound-parts will be dissolved, the will be picked up tissue-debris on that occasion by gel			
4.1		20471	10 x 10	250
4.2		20471	20 x 20	250
5.0	To the combustion or scalding belongs the hydro-amorphous gel to it as chilling effect to the pain-relief			
5.1		20478	6 g shot	10
5.2		20479	20 g shot	5
6.0	Sterile Hydrocolloid-bandage as individually liable wound-edition with good secretion-reception to the supply of combustions 2. degree as well as infected wounds. This Hydrocolloid-layer from sucks - and an ideal moist wound-climate manages source-capable particles and promotes the granulation and the epithelialism The secretion is picked up, that soaks hydrocolloid, on and adjusts itself the wound-structure optimally This gel-formation prevents a sticking together with the wound, the layer-change is painless through it. The bearer-foil protects from microorganisms and wetness, so that allows the gas-exchange surplus steam escapes			
6.1		20400	10 x 10 cm	100
6.2		20402	20 x 20 cm	100
7.0	Tampon-strips as fence-tulle, impregnate with hydrophobic, neutral vaseline salve-basis to the supply of flat cut - and combustion as well as. scalding-wounds. It favours the secretion-drain and provides good ventilation of the wound			

7.1		23315	10 x 10 cm	100
7.2		23315	10 x 20 cm	100
7.3		23315	10 x 30 cm	100
8.0	Sterile skin-friendly wound-layer with the sterile first-supply and for layer-changes with wounds of all the type and OP's with high suction-fortunes out of polyester / viscose, the wound-cleaning is accelerated by it, doesn't stick together, however			
8.1		30510	7 x 5 cm	100
8.2		30511	10 x 8 cm	100
9.0	Sterile band-aid-strips with high glue power, from fleece-reinforced Polyurethane, clinging, rice-firmly and doesn't lengthen, with skin-friendly polyacrylate glue coats to the seamless and steady wound-shutter. Sealed to 5 & 10 pieces			
9.1		30058	3 x 75 mm	100
9.2		30056	6 x 100 mm	100
10.0	Skin-glue for the skin-shutter, fast and agreeable wound-shutter for superficial skin-slice and skin-rips. No necessity of the local- anesthesia 1 ampoule contains 0,5 ml			
10.1		55146	6 x 12	10
11.0	Disinfectant: Alcoholic solution to the skin-disinfection, fast action-admission, blue, works against bacteria (incl. TBC), fungi, Rotaviruses and lipophilic viruses including HBV and HIV. Effecting time 15 sec, long-time and depth-effect. Skin-friendly pH of 6.5 For skin-desinfection before the transaction of the OP:			
11.1		53555	1 l blue alcoholic solution x 1	20
11.2		51340	5 l blue alcoholic solution x1	5
12.0	Skin-cream to the care and support of the regeneration extremely incriminated hands and skin of hand-disinfection			
12.1		41008	1 x 50 ml	10

13.0	Instrument-end-infection and cleaning: To the aldehyde-free disinfection and cleaning for instruments of all the types. Also instruments of aluminium, plastic or rubber been suitable. Effective against bacteria (incl.. TBC), fungi, Rotaviruses and lipophile viruses including HBV, HCV and HIV. Mild scent. No additional cleaning-intensifier necessary			
13.1		51412	1 x 5 l canister	30
14.0	Threads: Monofilamentous, resorbable, synthesis-thread and undyed. Smooth surface. High rip-solidity. Sure knot-glide-qualities. Minimal Tissue-reaction and saw-effect. Reabsorption-time 90 - 120 days For skin and intracutane wound-supply. Needle: 3 / 8 as circle cutting with accuracy-top. Thread-strength 4 / 0 in 3 / 0 and 45 cm			
14.1		551404	36 x 1	50
14.2		55401	36 x 1	50
14.3		55403	36 x 1	50
14.4		44097	36 x 1	50
14.5		46195	36 x 1	50
.	For facie and mucous membrane. Needle: 1 / 2 as circle flat round-body-needles Thread-strength 3 / 0 in 2 / 0 and 70 cm			
14.6		48174	36 x 1	50
14.7		44702	36 x 1	50
14.8		48175	36 x 1	50
14.9		53819	36 x 1	50
	Pro-Lene, not-resorbable, blue and synthesis-thread. Smooth surface. High rip-glide-quality. Sure knot-glide-quality. Minimal tissue-reaction and saw-effect. Reabsorption-time 90, 120 days For skin and intracutane wound-supply. Needle: 3 / 8 as circle cutting with accuracy-top Thread-strength 6 / 0 in 2 / 0 and 45 cm			
14.1		54328	36 x 1	50
14.2		55175	36 x 1	50
14.3		53207	36 x 1	50
14.4		55210	36 x 1	50
14.5		55177	36 x 1	50

14.1		55199	36 x 1	50
14.2		40098	36 x 1	50
14.3		55209	36 x 1	50
14.4		55208	36 x 1	50
15.0	Sterile, elastic, fleece-material and 100 % polyester wound-layers for all wounds from finely voluminous wound-edition with high suction-fortune out of polyester. It lets secretion diffused stuck not together into the well sucking part, fastens the wound-cleaning, and influences the cure-process positively through secured wound-silence. Reliable all around-shutter through especially well adhesive, skin-friendly polyacryle-glue			
15.1		30504	7 x 5 x 5	25
15.2		30505	10 x 8 cm x 5	25
16.0	Not-sterile swabs from cellulose in the clear-view-donor			
16.1		13349	1 role, 5 x 4 cm 300 swabs	150
17.0	Skin-coloured elastic Injection-Band-Aid-slices of the role (donor-carton), water and filth-rejects and individually hygienically one-sealed and out of rosin polyacrylate-glue			
15.1		30625	250 sections, 2 x 4 cm 1 cartons	25
18.0	Not-sterile lint-compresses, 8-fold and especially suction-strong			
18.1		40660	5 x 5 cm, 100 pcs	50
18.2		46644	10 x 10 cm, 100 pcs	50
19.0	Not-sterile loop-gaze-swabs of gauze DIN EN 14079, 20-fibred, from a lint-cut machine-manufactured, with protection-ring without x-ray-contrast-thread to the blood and secretion-reception, to the wound-cleaning and also to the skin-disinfection		Plum-big, 1000 pieces	50
19.1		15176	Plum-big, 1000 pieces	50
20.0	Porous glue-lint to the full-flat fixation of the bandage, stretch and white coloured			

20.1		51177	1 roles, 10 m of x 10 cm	50
20.2		52892	1 roles, 20 m of x 20 cm	50
21.0	Not-sterile fingers-tall as finger-bandage to the fixation of wound-editions as well as to the cover of surgically looked after wounds out of cotton and viscose			
21.1		24081	50 pieces in the carton	50
22.0	Not-sterile gauze DIN EN 14079 80 cm of weave-spread put 8-times on 10 cm of width, rolled, in the clear-view-donor			
22.1		12004	Role-length 5 m, 1 pieces	50
22.2		12005	Role-length 10 m, 1 pieces	50
23.0	Not elastic tape-bond, very much move-solid, crosswise and alongside tear-able, with well adhesive Zinc oxide-rubber glue. The jag-edge eases the removal, avoids edge-threads and lets bandage-tours be liable well one on top of the other			
23.1		30081	10 m, 2,5 cm of diameter, 6 pieces	150
24.0	Elastic fixation bandage as gripping, stable, porous and unlined supple bandages			50
24.1		43197	In the carton 4 m of lengthened length, 4 cm, 50 pieces	50
24.2		51190	In the carton 4 m of lengthened Länge, 10 cm, 50 pieces	50
25.0	Duration-elastic bandages as fixation-bandages for extremities with compressing wound-supply or as rail-associations to the supports and unburdens. They have particular lengthening-behaviour and nestle all body-forms with lasting seat well for itself. The fine tissue is permeable and skin-amicable through her / its / their cotton			50

25.1		19492	In the carton, 5 m of lengthened length, 10 cm, 10 pieces	50
25.2		19494	In the carton, 5 m of lengthened length, 15 cm, 10 pieces	50
26.0	Not-sterile net-bandage as wide-stitched, high-elastic net-pants to the simple and timesaving fixation from wound-editions of all types after its surgical supply 25 m and folded in the donor-carton			50
26.1		24253	For head, 1 pieces	25
26.2		24252	For extremities, 1 pieces	25
26.3		24254	For torso, 1 pieces	25
27.0	Not-sterile pant-bandage from seamless and knitted material to the fixation of compresses with surgically looked after wounds 20 m long and packs in the piece			25
27.1		24004	For arm, 1 roles, 6,5 cm	25
27.2		24005	For leg, 1 roles, 8,5 cm	25

Prices, payment and delivery conditions (Preise, Zahlungsbedingungen und Lieferbedingungen)

Item	Description	Qty	Remarks
1	Multiuse Containers ISO 1 DD 10' Container	3	as described
2	medical and non medical equipments inventory	see list	as described
Containers Manufacturer (Hersteller)		European Union	

Products Manufacturer (Hersteller)	Different countries (Great Britain, Germany, France, China, Indonesia, India and Pakistan)
Net value (Nettowarenwert)	450.000,00 € Euro
Discount (Nachlass)	00,00 € Euro
VAT amount in % (MwSt. in %)	Not included
VAT amount (MwSt. Betrag)	00,00 € Euro
Total amount (Gesamtbetrag)	450.000,00 € Euro
Payment (Bezahlung)	Prepayment (100 %) - P / P - (100 % auf MTN-Konto)
Expiration of the proforma invoice validity deadline (Angebot endet spätestens zum)	31. December 2018
Delivery time (Lieferzeit)	360 days for two Hospitals after receipt of the full payment and order of 10 Hospitals
Delivery (Lieferung)	Ex Work or Tax Free Zone (is ready for transport on axles). The third container have to be loaded on trailer (Truck and Trailer must be purchased for that) See the short review of sale and delivery conditions
Delivery conditions (Lieferbedingungen)	Fixed in special Agreement paper
Warranty (Garantie)	Two years
Proforma Invoice (Proforma Rechnung)	RB-ECU-MESorDRA-05-2017-FP-E
Invoice (Rechnung)	when ordering
Ordering designation (Bestellungsbezeichnung - MTN)	BRD-RB-ECU-MESorDRA-100-FP0517
Customer number (Kunden-Nr.)	

The offer includes

The container workplaces as described above
 The quality inspection report
 CSC label for container
 Training of staff Ex Work or in Tax Free Zone in Germany

The offer does not include

Transportation

Short review of sale and delivery conditions (Terms and Conditions)

When our offer is quoted in USD the goods are to be delivered EXW = Ex-Works behind the gate of the production site and is subject to our standard terms and conditions. When our offer is quoted in USD, it means the price can not be fixed for all the validity time of the offer - due to invoicing according to daily rate (EUR / USD)

If the products (various components) mentioned in the offer are not included in the scope of delivery for any reason, the MTN is allowed to deliver new models products without rejection from the customer side

The quantity of goods depends of their availability. Medical Trade Network and there partners can supply these goods to any country but the customer must ensure that they are able to comply with local customs procedures and requirements. It means that all products are supplied under the strict condition that the final recipient is licensed to receive these products. The customer is liable for the purchases were appropriate, they must eventually request a permit by German Federal Bureau of Economics and Export Control BAFA*) to deliver such goods to the target territory. The customer is liable in eventual export ban against the authorities of the Federal Republic of Germany and / or the European Union, where such offenses the export to the country of destination. Medical Trade Network and his partner enterprises does not accept any liability for goods impounded, confiscated, destroyed or refused to entry into any country through lack of compliance with regulations or failure to obtain an import license or pre-shipment inspection. Cancellation of orders after 24 hours of confirmation, Medical Trade Network and his partner enterprises will charge a restocking fee of 45 % of the order volume. By deviations of Mobile Hospital sketches and the content of Medical and Non-Medical equipments of the Mobile Hospital Containers in the proforma invoice and by the final product these are caused by production shortfalls. in the manufacturing factories; because we want decline any collateral damage of the products function capabilities. When ordering low quantities of medical products, the MTN is not able to supply customers with own MTN-OEM goods but these can be obtained by our partners from different countries

If the medical devices in the Offer for any one reason are no longer manufactured, the MTN is obligated to find for the buyer suitable devices but in the new version. For the purchase of Mobile Hospitals, medical equipment or parts, the buyer bears the responsibility or liability which may arise therefrom and the importation of these goods in any country. Delivery times do not include the European holidays

Changes in this signed offer are only valid after written agreement and signature of the two parties (the seller and the buyer)